

Sample Bedroom Layouts



One Bedroomed Apartments

These apartments are situated within the same building as the school and include one air-conditioned/heated bedroom [restricted hours], a bathroom, a kitchen, a TV and a telephone. Weekly cleaning and change of bed linen and towels are also included. These apartments are ideal for individuals who would not like to share their apartment with more than two other students.

Shared Bedroom [ONESHR]

Students will share a private apartment with up to two other students.

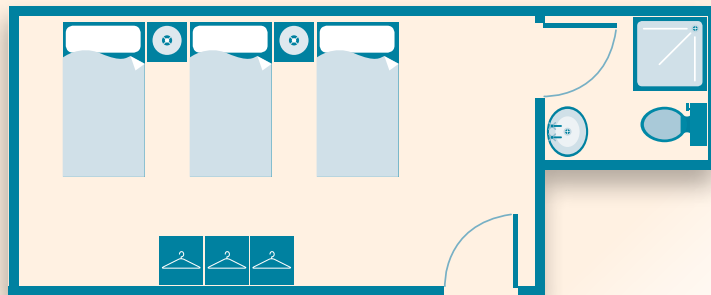

Twin / Double Bedroom [ONETWN]

Students will share a private apartment with another student.

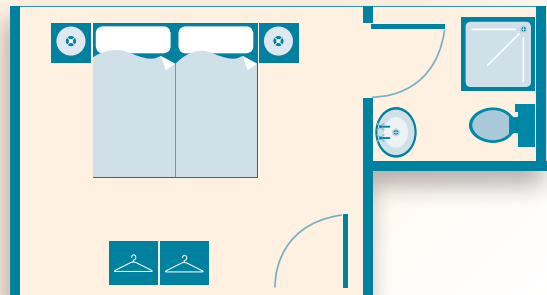
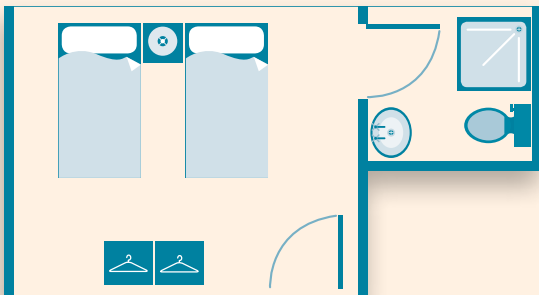

Single Bedroom [ONESGL]

Students will have their own apartment.

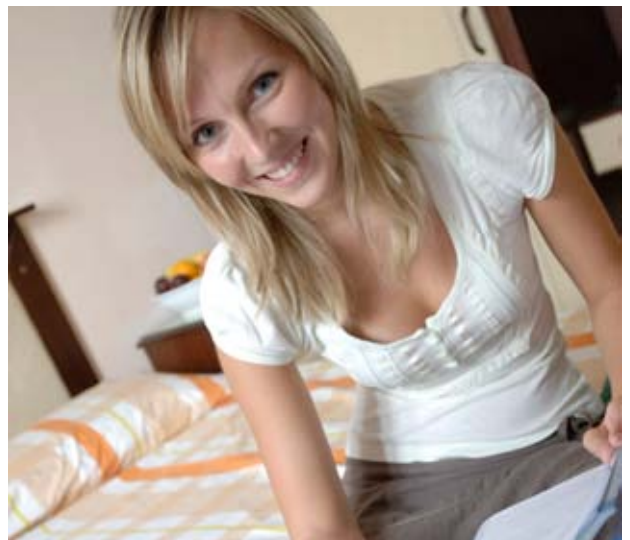
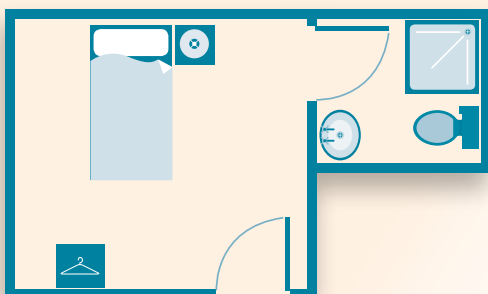

Actual floor plans are not to scale and room layouts may vary from the illustrations featured.

Shared Apartments

These apartments are situated within the same building as the school and include two or three air-conditioned/heated bedrooms [restricted hours], one to three bathrooms, a kitchen, a TV and a telephone. Weekly cleaning and change of bed linen and towels are also included. These apartments are ideal for individuals who would like to share an apartment with other students.

Shared Bedroom [APTSHR]

Students will share a triple bedroom with up to two other students. Bathroom/s and other facilities in the apartment will be shared with other students.

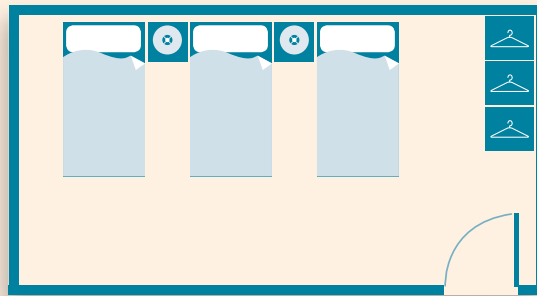

Twin / Double Bedroom [APTTWN]

Students will share a twin bedroom with another student. Bathroom/s and other facilities in the apartment will be shared with other students.

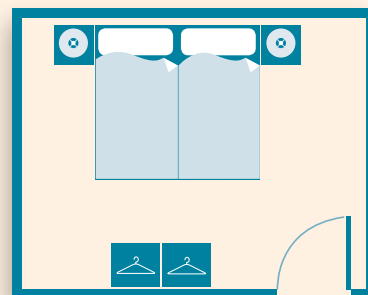
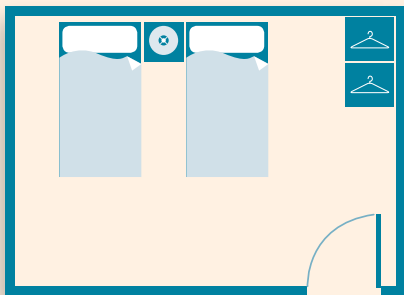

Single Bedroom [APTSGL]

Students will have their own bedroom. Bathroom/s and other facilities in the apartment will be shared with other students.

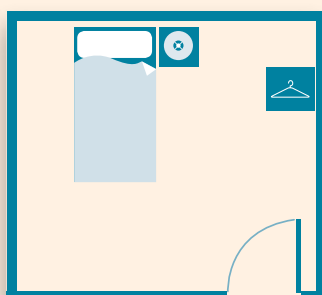

Actual floor plans are not to scale and room layouts may vary from the illustrations featured.

Hostel

The hostel is situated across the road from the school and consists of 15 bedrooms with private showers and a shared kitchen. Bedrooms include a fan, telephone, TV, fridge and tea/coffee-making facilities. Weekly cleaning and change of bed linen and towels are also included. This type of accommodation is ideal for individuals who would like to enjoy student life but want the privacy of their own bedroom and shower.

Shared Bedroom with private shower [HOSSHR]

Students will share a triple bedroom with a private shower. The kitchen in the hostel will be shared with other students.

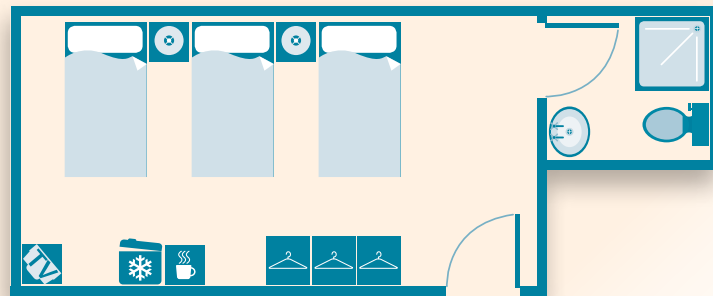

Twin / Double Bedroom with private shower [HOSTWN]

Two students travelling together will share a twin / double bedroom with a private shower. The kitchen in the hostel will be shared with other students.

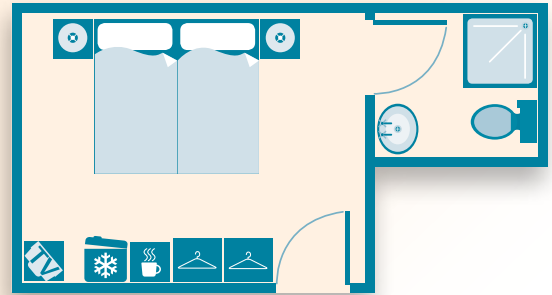
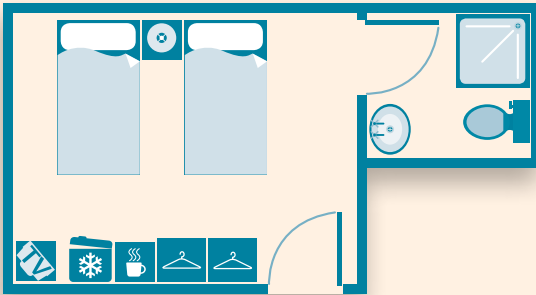

Single Bedroom with private shower [HOSSGL]

Students will have their own bedroom with a private shower. The kitchen in the hostel will be shared with other students.

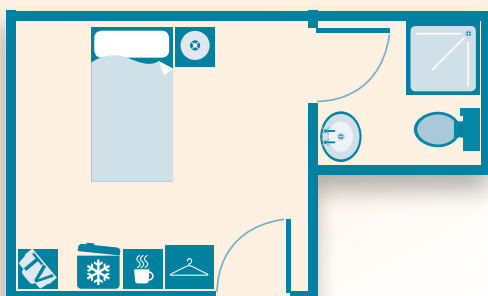

Actual floor plans are not to scale and room layouts may vary from the illustrations featured.

Student Houses

The student houses are situated across the road from the school and consist of 10 bedrooms with 5 shared bathrooms and a shared kitchen. Bedrooms include a fan. Weekly cleaning and change of bed linen and towels are also included. This budget accommodation is ideal for individuals who would like to experience student life to the full.

Shared Bedroom [HSESHR]

Students will share a bedroom with up to two other students. The kitchen, bathrooms and other facilities at the house will also be shared with other students.

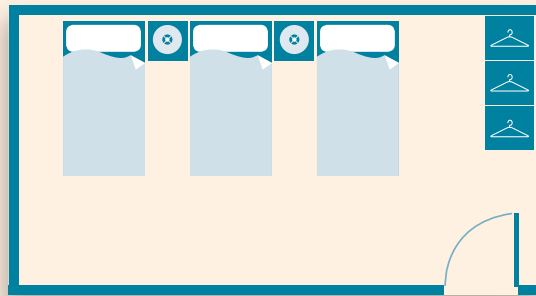

Actual floor plans are not to scale and room layouts may vary from the illustrations featured.



Host Families

All Clubclass families are carefully selected and situated within walking distance of the school. Accommodation is on full board basis and includes breakfast, packed lunch and dinner. Weekly laundry and change of bed linen are also included. Our English-speaking families are ideal for students who would like to reside in a family environment, experiencing the Maltese way of life.

Shared Bedroom [FAMSHR]

Students will share a triple bedroom with up to two other students. Bathroom/s and other facilities at the family will be shared with other students.

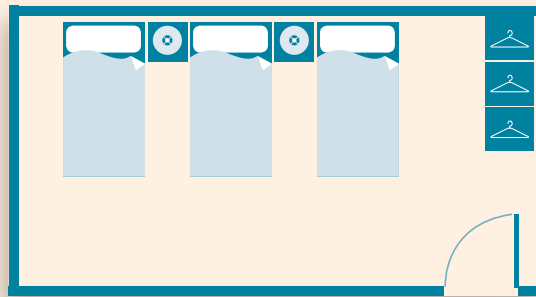

Twin / Double Bedroom [FAMTWN]

Students will share a twin bedroom with another student. Bathroom/s and other facilities at the family will be shared with other students.

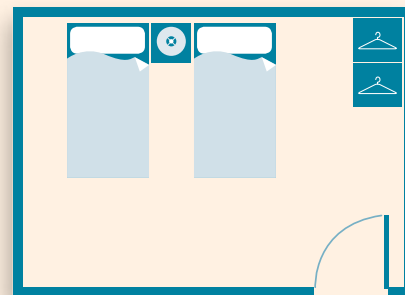
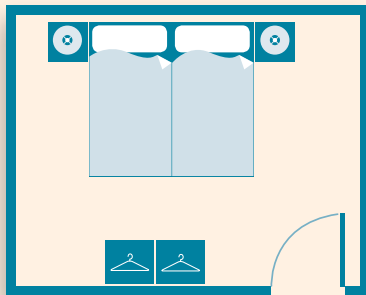

Single Bedroom [FAMSGL]

Students will have their own bedroom. Bathroom/s and other facilities at the family will be shared with other students.

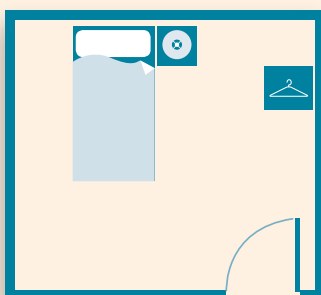

Actual floor plans are not to scale and room layouts may vary from the illustrations featured.

Campus

Campus accommodation is one of the accommodation options for juniors on the Teenskool programme. When the campus accommodation is set up, juniors will only have access to their bedroom and shower. The first image is a plan of the accommodation when it is used as an apartment and the second image is a plan of the accommodation when it is used as campus accommodation.

Apartment Layout

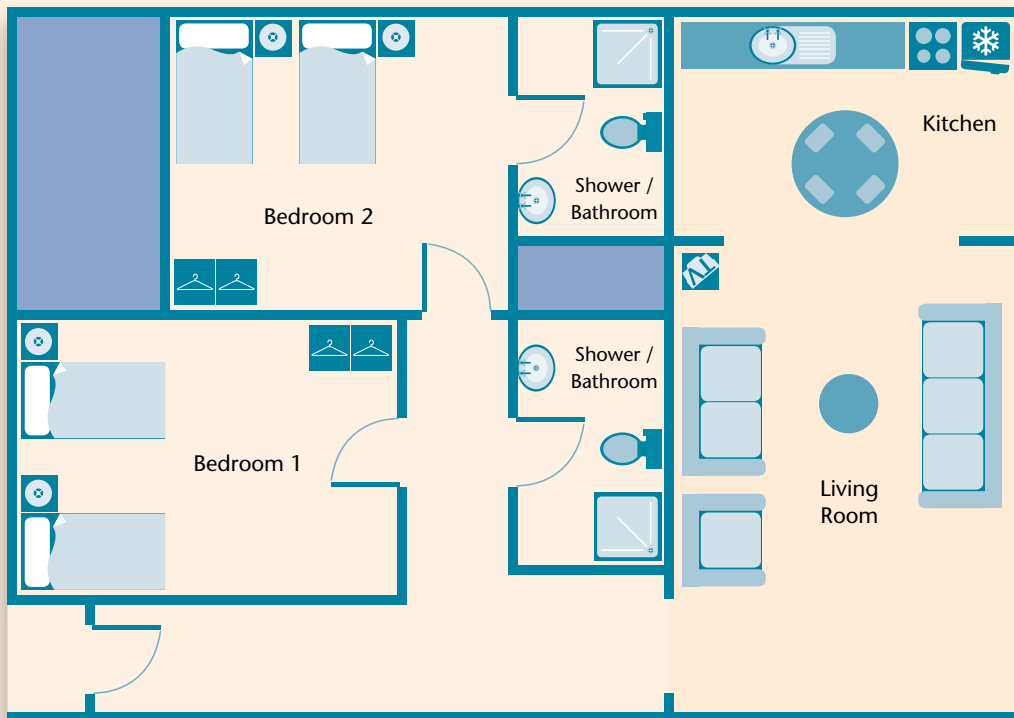

Campus Layout

